

**Ground connection for pick-up wiring, Rotax Engine Series Type 912****Mandatory**

- Subject:** improvement of ground connection for the screening braid of pick-up wiring and charging cable
- Engines affected:** All engines of Series 912 A, beginning with engine no. **4,076.064**, since introduction of the SMD-ignition unit.
- Reason:** On the current installation of the ignition unit, troubles could **occur** in areas with heavy radio transmission. Because of the good **result** of the respective tests for EMC (electro magnetic **compatibility**) all the engines affected have to be reworked.
- Compliance:** The necessary rework has to be carried out at the next **100 h** check, but at the latest by **15th March 1995**.
- Remedy:** Optimizing of the grounding in accordance to the instructions overleaf.
- Accomplishment:** The necessary measures to be taken and confirmed by the engine producer or by persons authorized from the Aviation Authorities.
- Approved:** The statement of this Service information has been approved by ACG on **1. FEB. 1995**

Gunskirchen, 1995 01 30
BOMBARDIER-ROTAX GmbH

ppa.

Dr. Heinz Lippitsch

i.A.

Ernst Möseneder



Instruction for rework

- 1) Remove Allen screw ● **M5x25** and the clamp ● with **rubberlined** inside.
- 2) Slide new clamp ● (without rubberlining) over the cable-assemblies ● and ● so far that the screening braid rests completely in the clamp.
- 3) The **shorting** cables have to be furnished with screening over the complete length. The **screening** to be attached via short connection prices on the Alien screw ● together with grounding cable ●. On the ignition switch side the screening of the shorting cable has to be securely connected to ground too.
- 4) Attach new grounding cable ● *part-no. 965 787*, damp ● *part-no. 8511 79* and both electronic modules by Alienscrew to ignition coil bracket ●. Tightening torque **5,5 Nm (50 in lb)**

■ **ATTENTION:** The shrink tube ● must not rest in clamp.

- 5) Remove hex. hd. screw ● **M6x16** from intake manifold and attach second end of new grounding cable ● together with the 4 already existing grounding cables ●. Tightening torques **10 Nm (90 in lb)**

- 6) Perform trial run inclusive ignition check.

- 7) New parts needed:

1x 851 119 clamp
 1x 965 787 grounding cable

A **WARNING:** **Non-compliance** with this **TB** could result in engine damage and personal injury.

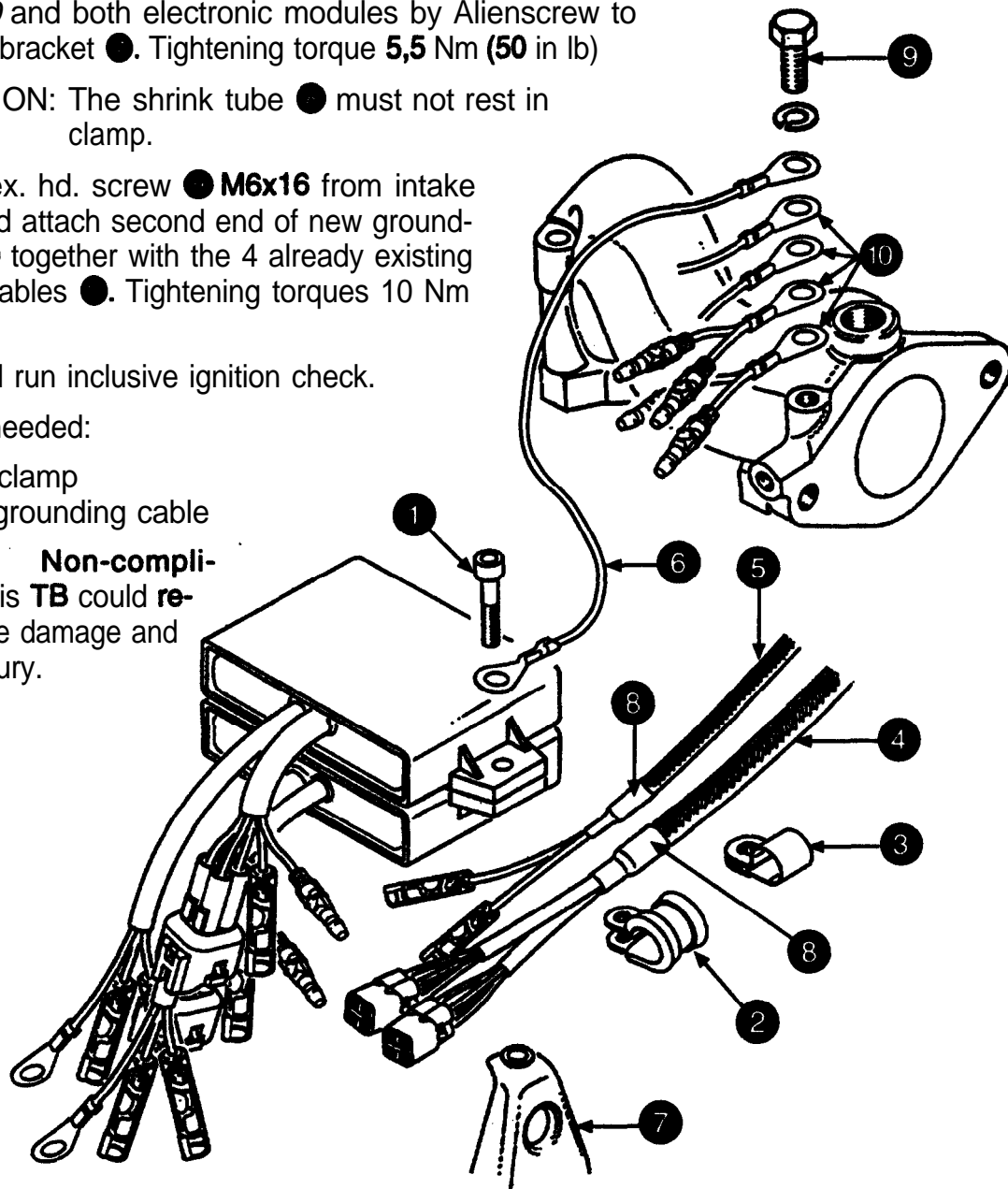

AIRWORTHINESS DIRECTIVE

No. 62

Affected Engines: Engines for Powered Sailplanes, **Rotax 912 A Series**

Subject: **SMD-Ignition for Rotax 912 A Series, Engines beginning with S/N 4,076.064 and subsequent_**

Reason: **Ignition troubles would occure in aereas with heavy radio tranmission.** }

Action and Compliance: **See Bombardier Rotax Technical Bulletin No. 912-07 issued on January 1, 1995, which becomes herewith part of this AD.**

Accomplishment and Logbook entry: **The required action has to be accomplished by an approved service station or by a licensed/qualified person and to be entered in the powered sailplane log.**